

Key

- ① — Decaflex Top Coat applied in strict accordance with Sika Plastics Project Specification
- ② — Decaflex Embedment Coat with Reemat Premium GFM
- ③ Existing substrate prepared and primed in strict accordance with Sika Liquid Plastics Project Specification
- ④ Sika Liquid Plastics Type 'D' Decotrim mechanically fixed; fully reinforced waterproofing system terminated on the external drip edge

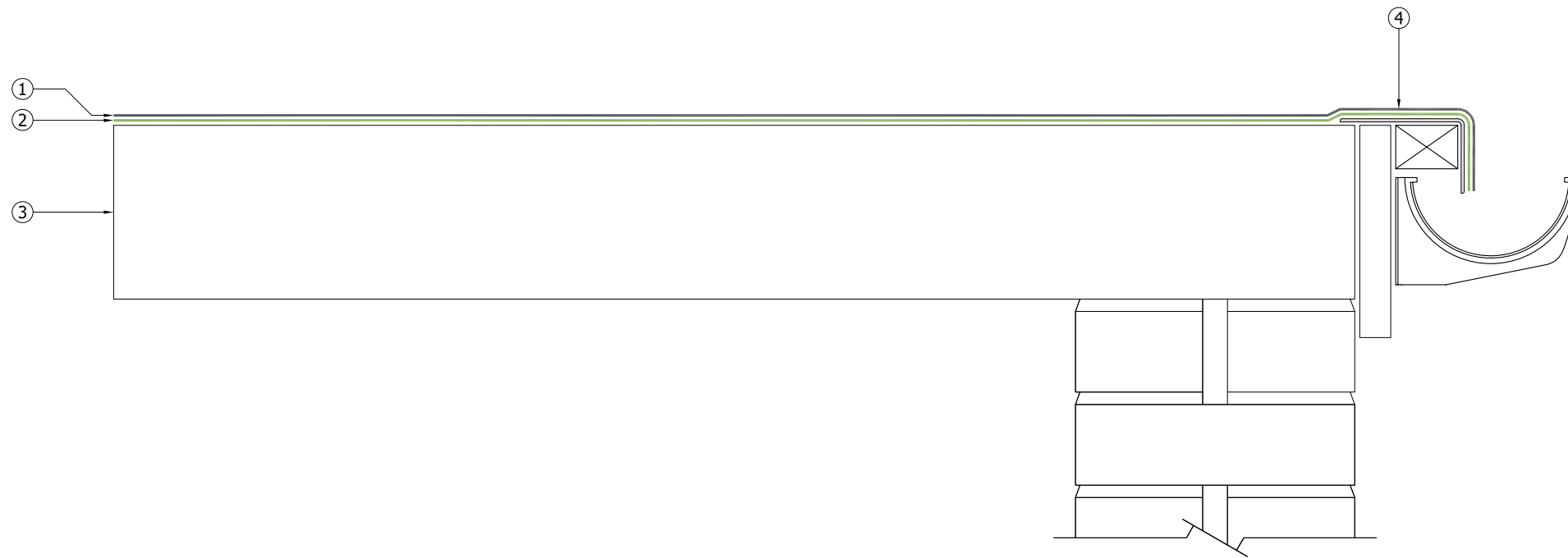

Sika Liquid Plastics  
Sika House  
Miller Street  
Preston  
Lancashire PR1 1EA  
Telephone: 01772 259781  
Email: [technical.customer.services@uk.sika.com](mailto:technical.customer.services@uk.sika.com)  
Web: [www.liquidplastics.co.uk](http://www.liquidplastics.co.uk)

This drawing is solely intended to illustrate the correct application of Sika Liquid Plastics products and systems, it must be read in conjunction with the appropriate specification and current issue of relevant Technical Data Sheets. All elements bearing reference to structural and/or thermal design are shown indicatively and **should not be used** in whole or in part for any aspect of project design without consulting the relevant authorities.

For refurbishment projects, all aspects of the existing roof are deemed to be fully compliant with BS 6229:2003 (Code of Practice for Flat Roofs with Continuously Supported Coverings) or improved upon for instances where these standards are not met.

Site-specific details not covered by our range of Standard Details can be obtained by providing relevant information to the email address shown.

Project No:

DWG No: Revision

Project:

Drawing Title:  
Waterproofing Termination Detail  
showing D-Type Decotrim  
to an external gutter

Scale: NTS @ A3 Drawn:

Date:

